

IDLE SPEED INSPECTION

EM1XI-01

1. **When using a hand-held tester or OBD II scan tool.**
 - (a) Connect a hand-held tester to the Controller Area Network Vehicle Interface Module (CAN VIM). Then connect the CAN VIM to the Data Link Connector 3 (DLC3).
 - (b) Please refer to the hand-held tester operator's manual for further details.
 - (c) Switch the air conditioning OFF.
 - (d) Race the engine at 2,500 rpm for approx. 90 seconds.
 - (e) Check the idle speed.

Idle speed: 650 to 750 rpm

(Transmission in neutral position)

If the idle speed is not as specified, check the air intake system.

- (f) Disconnect the hand-held tester or OBD II scan tool from the DLC3.

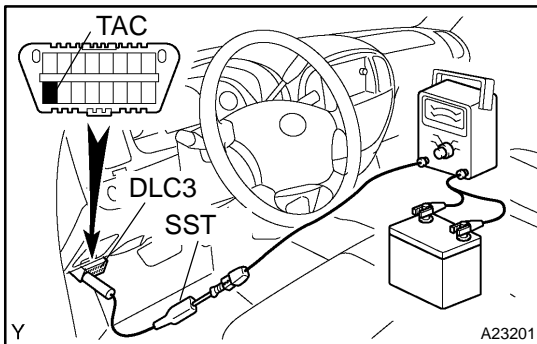

2. **When not using a hand-held tester or OBD II scan tool.**

- (a) Using SST, connect the tachometer probe to terminal TAC of the DLC3.
SST 09843-18030
- (b) Switch the air conditioning OFF.
- (c) Race the engine at 2,500 rpm for approx. 90 seconds.
- (d) Check the idle speed.

Idle speed: 650 to 750 rpm

(Transmission in neutral position)

If the idle speed is not as specified, check the air intake system.

- (e) Disconnect the tachometer from the DLC3.